

# SADAF ELECTRIC INDUSTRIES CO.



## EXOTHERMIC WELDING SYSTEM



## THE COMPLETE PROTECTION

For Every Application and Industry

Universal Expert  
For Your  
Perfect Electrical  
Infrastructure & Safety

[www.seico-sa.com](http://www.seico-sa.com)

# EXOTHERMIC WELDING SYSTEM

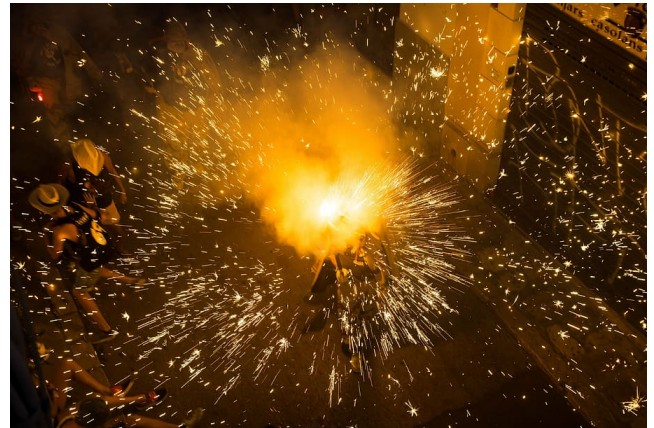

Exothermic welding is an innovative new way to connect two metals.

**SEICOWeld** Exothermic System uses the high-temperature reaction of copper oxide and aluminium inside a semi-permanent graphite mould, to form electrical connections (mainly between copper and copper or copper and steel).

No outside source of power or heat is needed when using the exothermic system.

It is light and completely portable, making it ideal for field use. Creating an exothermic joint is a simple procedure which requires a mould, welding powder, handle clamp and various tools and cleaning accessories.

## Typical Applications include:

- Sub Stations and Power Plants
- T&D Distribution Lines
- Rail Connections
- Telecommunications

## Features:

- 1 High current carrying capacity
- 2 High current surge resistance
- 3 Sparkles connections
- 4 Stable transition resistance
- 5 High corrosion resistance
- 6 Good mechanical parameters
- 7 Quick connection time
- 8 Lightweight (kg) equipment needed
- 9 Can be used safely with minimum training
- 10 Can be used for over 45 standard connection configurations.
- 11 Completely portable

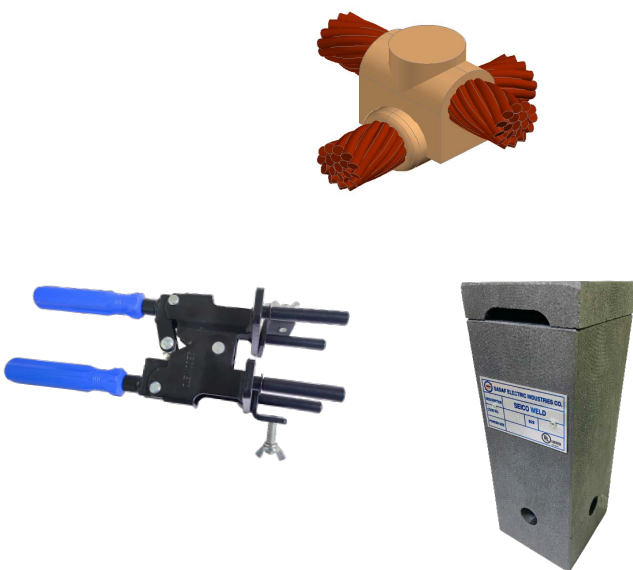



BS EN 62561-1

UL-467

**MOULDS:**

The **SEICOWeld** system of exothermic welding uses moulds (to contain the exothermic reaction) for creating safe and robust connections. Different types of moulds are available (use depends on the requirements of the project). These moulds can be used for cable to cable connections, cable to a rod, rod to rod connections, cable to reinforcing bar connections, bar to bar and bar to earth rod connections.

**Graphite Moulds:**

Market-leading SEICO WELD graphite moulds are extremely robust and capable of producing over 45 connections each.

**SEICO WELD Powders:**

Our powders are a high-quality mixture of copper oxide and aluminium, inside plastic cartridges, and include the required metal retaining disc. Each SEICOWeld connection uses one disc. The starting powder is compacted at the bottom of each cartridge and the Safeweld powder is on top. Starting powder is released by firmly tapping the base of the cartridge. SEICOWeld powder is not explosive, shock-sensitive or subject to spontaneous combustion and is supplied in the following pack sizes: 25g | 32g | 45g 65g | 90g | 115g 150g | 200g | 250g.

**Handle Clamps:**

**SEICOWeld** Handle Clamps are required to hold graphite moulds and conductors in place while the connection is being made. Three sizes of Handle Clamps cover the range of connections which can be made.

**SEICO WELD Tool Kit:**

Includes these important tools and cleaning materials to aid your welding program:

- Tape cleaning brush
- Cable cleaning brush
- Mould cleaning brush
- Mould cleaning scraper
- Flint gun
- Replacement flints
- Disc container
- Duxseal Jointing Compound (1lb)
- Butane torch
- Heat resistant gloves
- Optical safety glasses

**SEICO WELD Tool Kit for Bar Connections:****Includes:**

- Tape cleaning brush
- Mould cleaning brush
- Mould cleaning scraper
- Flint gun

**SEICO WELD Tool Kit for cable connections:****Includes:**

- Tape Cleaning Brush
- Cable Cleaning Brush
- Mould Cleaning Brush
- Mould Cleaning Scraper
- Flint Gun

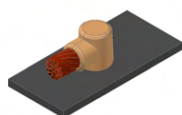

CABLE TO STEEL SURFACE & PIPE

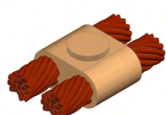

CABLE TO CABLE CONNECTION

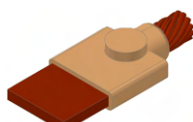

CABLE TO TAPE CONNECTION



CABLE TO REINFORCING BAR

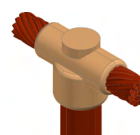

CABLE TO EARTHROD CONNECTIONS

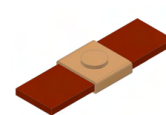

TAPE TO TAPE CONNECTION

**WELD CONNECTION**

Conforms to IEC 62561-1 and UL 467

**SEICOWeld Connection Tips**

When making a copper wire connection for ground rods or other materials, put the **SEICOWeld** powder into the graphite mould. You only need to ignite it to start the welding process. The result will be a clean and smooth connection surface, which has been field proven. It can also be used on other metals, such as: Iron, steel, railway track, wrought and cast iron, bronze, nichrome and bronze.

**SEICOWeld** exothermic welding can be used in various applications to ensure excellent working connections. Many professionals trust in **SEICOWeld** for:

- Lightning and surge protection
- Grounding electrical works
- Railway construction
- Cathodic construction

**TYPES OF MOULDS**

Conforms to IEC 62561-1 and UL 467

**SEICOWeld Connection Tips**

**SEICOWeld** offers more than one type of moulds. There are "One Time Moulds" and "Graphite Moulds" with different shapes to suit different welding needs. "ONE TIME MOULD" is made of ceramic suitable for "One Off" welding work. "GRAPHITE MOULD" is made of high quality graphite suitable for quality welding work and can be used several times. It provides the following advantages:

1. A smooth metal connection that will not loosen or corrode.
2. Not affected by high current surge or over current.
3. No need for an external welding machine.
4. Can use lightWeight (kg) and cheap equipment.
5. Virtually maintenance free

**SEICO MOULD PARTS AND CROSS-SECTION**

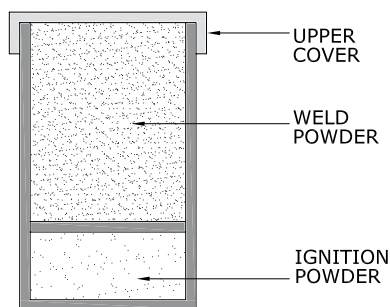
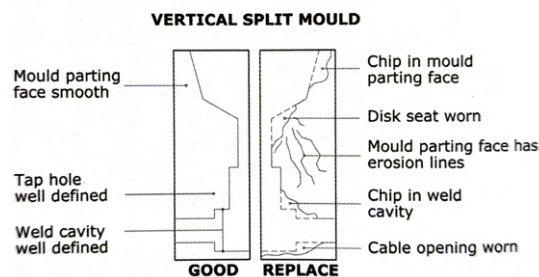
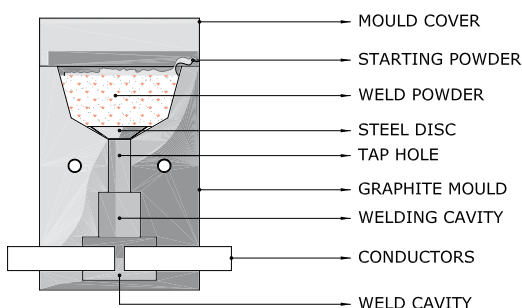

SEICOWELD Powder Selection	
P - 15	P - 115
P - 25	P - 150
P - 32	P - 200
P - 45	P - 250
P - 65	P - 2 x 150
P - 90	P - 2 x 200
	P - 2 x 250

**WELDING SYSTEM INSTRUCTION STEPS**

**1**

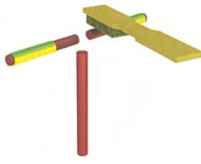

When using insulated cables, first remove 150mm of the conductor insulation and clean away all the dust and oxides with the mould brush, and/or card cloth brush.

**2**

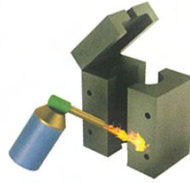

Preheat the welding mould with a welding torch or ignite a box of welding powder to remove the moisture, before starting the first weld.

**3**

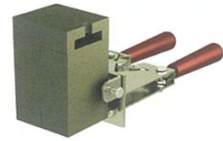

Connect the handle clamp to the hole and separate the two arms to open the mould. Next, fit the conductors and leave a 5- 6mm gap on the other conductor

**4**

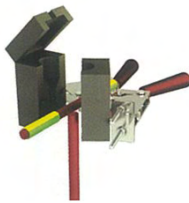

Close the mould with the handle clamp and put the STEEL DISC on the top hole (the conical side of the disc should be at the bottom)

**5**

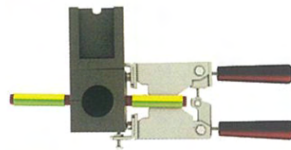

Pour the weld powder into the crucible (located in the upper portion of the powder box).

**6**

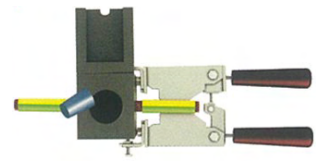

The ignition powder is located on the bottom of the powder canister. Put it on the lip of the crucible and on top of the weld powder to simplify powder ignition

**7**

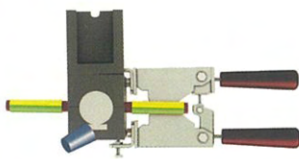

Ignite the flint ignitor beside the ignition powder. Pull away the flint ignitor once it ignites to avoid damage.

**8**

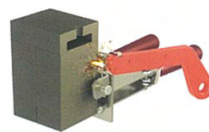

After one minute, separate the two arms of the handle clamp to open completely. Extra care should be taken so you don't damage the mould.

**9**

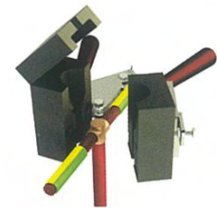

Completely clean the mould by using the mould scraper and mould brush. You can continue welding as long as the mould is still warm.

**Conductor Selection Table**

Conductor Size	Number of Wires per Diameter	Overall Diameter
10mm <sup>2</sup>	7x 1.35mm	4.10mm
16mm <sup>2</sup>	7x1.70mm	5.10mm
25mm <sup>2</sup>	7x2.10mm	6.30mm
35mm <sup>2</sup>	7x2.50mm	7.50mm
50mm <sup>2</sup>	19x1.80mm	9.00mm
70mm <sup>2</sup>	19 x 2.10mm	10.50mm
95mm <sup>2</sup>	19x2.52mm	12.50mm
120mm <sup>2</sup>	19x2.80mm	14.00mm
150mm <sup>2</sup>	37x2.25mm	15.70mm
185mm <sup>2</sup>	37x2.50mm	17.50mm
240mm <sup>2</sup>	61 x2.25mm	20.20mm
300mm <sup>2</sup>	61 x2.50mm	22.50mm
400mm <sup>2</sup>	61 x2.89mm	26.00mm
500mm <sup>2</sup>	61 x3.23mm	29.10mm

Concrete Steel Re-Bar	
Normal Size	Overall Dia
6mm	7.20mm
8mm	9.60mm
10mm	12.00mm
12mm	14.40mm
14mm	16.80mm
16mm	19.20mm
20mm	24.00mm
25mm	30.00mm
32mm	38.40mm

Standard Overall Dia for Earth Rod	
Actual	Nominal" (mm)
14.3mm	5/8" (15.88)
17.2mm	3/4" (19.05)
12.7mm	1/2"

**EXOTHERMIC WELDING MOULDS** are designed and manufactured to fit different types and sizes of copper conductors, earth rods & concrete steel re-bar.

**HOW TO ORDER:**

Choose the appropriate connection from our SEICO-Weld Connection Chart. Check your run cable size. The cell where the two sections meet, shows the powder size needed to carry out the connections.

**Example :**

If you require CABLE to CABLE (Straight Horizontal) If you need CABLE to CABLE (straight horizontal) with 35mm<sup>2</sup> and 150mm<sup>2</sup> conductors, you should

**Order:**

1. CC-L-150-35 (Mould Catalogue No.)
  2. P- 90 (Powder Catalogue No.)
- See table for clarification.

Other types and sizes are available upon request.

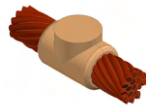

STRAIGHT HORIZONTAL (CC-L)

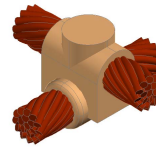

HORIZONTAL CROSS TAP (CC-XS)

**CABLE TO CABLE CONNECTION (Straight)**

Conforms to IEC 62561-1 and UL 467

Code	Stranded/Solid Circular Conductor Size (A) (mm <sup>2</sup> )	Powder	Handle Clamp
CC-L-16	16	P-32	HC-M
CC-L-25	25	P-32	HC-M
CC-L-35	35	P-32	HC-M
CC-L-50	50	P-45	HC-M
CC-L-70	70	P-65	HC-M
CC-L-95	95	P-90	HC-M
CC-L-120	120	P-115	HC-M
CC-L-150	150	P-115	HC-M
CC-L-185	185	P-150	HC-M
CC-L-240	240	P-200	HC-M
CC-L-300	300	P-250	HC-M
CC-L-400	400	P-2x150	HC-L

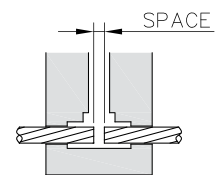

**CABLE TO CABLE CONNECTION (HORIZONTAL CROSS TAP)**

Conforms to IEC 62561-1 and UL 467

Code	Stranded/Solid Circular Conductor Size (A) (mm <sup>2</sup> )	Stranded/Solid Circular Conductor Size (B) (mm <sup>2</sup> )	Powder	Handle Clamp
CC-XS-50-50	50	50	P-150	HC-M
CC-XS-70-70	70	70	P-200	HC-M
CC-XS-95-95	95	95	P-250	HC-M
CC-XS-120-120	120	120	P-2x150	HC-M
CC-XS-150-150	150	150	P-2x200	HC-L
CC-XS-185-185	185	185	P-2x250	HC-L
CC-XS-240-240	240	240	P-3x200	HC-L
CC-XS-300-300	300	300	P-3x250	HC-L



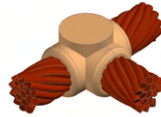

TEE HORIZONTAL (CC-TH)

Code	<b>CABLE TO CABLE CONNECTION (TEE)</b>			
	Conforms to IEC 62561-1 and UL 467			
	Stranded/Solid Circular Conductor Size (A) (mm <sup>2</sup> )	Stranded/Solid Circular Conductor Size (B) (mm <sup>2</sup> )	Powder	Handle Clamp
CC-TH-16-16	16	16	P-45	HC-M
CC-TH-25-25	25	25	P-45	HC-M
CC-TH-35-35	35	35	P-45	HC-M
CC-TH-50-50	50	50	P-90	HC-M
CC-TH-50-35	50	35	P-65	HC-M
CC-TH-50-25	50	25	P-65	HC-M
CC-TH-70-70	70	70	P-90	HC-M
CC-TH-70-50	70	50	P-90	HC-M
CC-TH-70-35	70	35	P-65	HC-M
CC-TH-70-25	70	25	P-65	HC-M
CC-TH-95-95	95	95	P-115	HC-M
CC-TH-95-70	95	70	P-90	HC-M
CC-TH-95-50	95	50	P-90	HC-M
CC-TH-95-35	95	35	P-90	HC-M
CC-TH-120-120	120	120	P-150	HC-M
CC-TH-120-95	120	95	P-150	HC-M
CC-TH-120-70	120	70	P-90	HC-M
CC-TH-120-50	120	50	P-90	HC-M
CC-TH-150-150	150	150	P-200	HC-M
CC-TH-150-120	150	120	P-150	HC-M
CC-TH-150-95	150	95	P-150	HC-M
CC-TH-150-70	150	70	P-90	HC-M
CC-TH-185-185	185	185	P-200	HC-M
CC-TH-185-150	185	150	P-200	HC-M
CC-TH-185-120	185	120	P-200	HC-M
CC-TH-240-240	240	240	P-2x150	HC-M
CC-TH-240-150	240	150	P-200	HC-M
CC-TH-240-120	240	120	P-200	HC-M
CC-TH-300-300	300	300	P-2x200	HC-L
CC-TH-300-240	300	240	P-2x200	HC-L

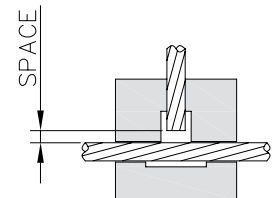

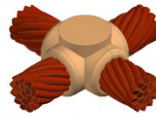

HORIZONTAL CROSS (CC-X)

<b>CABLE TO CABLE CONNECTION (CROSS)</b>				
<b>Conforms to IEC 62561-1 and UL 467</b>				
<b>Code</b>	<b>Stranded/Solid Circular Conductor Size (A) (mm<sup>2</sup>)</b>	<b>Stranded/Solid Circular Conductor Size (B) (mm<sup>2</sup>)</b>	<b>Powder</b>	<b>Handle Clamp</b>
CC-X-16-16	16	16	P-65	HC-M
CC-X-25-25	25	25	P-45	HC-M
CC-X-35-35	35	35	P-65	HC-M
CC-X-50-50	50	50	P-90	HC-M
CC-X-50-35	50	35	P-90	HC-M
CC-X-50-25	50	25	P-90	HC-M
CC-X-70-70	70	70	P-115	HC-M
CC-X-70-50	70	50	P-115	HC-M
CC-X-70-35	70	35	P-115	HC-M
CC-X-70-25	70	25	P-115	HC-M
CC-X-95-95	95	95	P-150	HC-M
CC-X-95-70	95	70	P-150	HC-M
CC-X-95-50	95	50	P-115	HC-M
CC-X-95-35	95	35	P-115	HC-M
CC-X-120-120	120	120	P-200	HC-M
CC-X-120-95	120	95	P-200	HC-M
CC-X-120-70	120	70	P-150	HC-M
CC-X-120-50	120	50	P-150	HC-M
CC-X-150-150	150	150	P-250	HC-M
CC-X-150-120	150	120	P-250	HC-M
CC-X-150-95	150	95	P-200	HC-M
CC-X-150-70	150	70	P-150	HC-M
CC-X-185-185	185	185	P-2x150	HC-M
CC-X-185-150	185	150	P-250	HC-M
CC-X-185-120	185	120	P-250	HC-M
CC-X-240-240	240	240	P-2x250	HC-L
CC-X-240-150	240	150	P-2x200	HC-L
CC-X-240-120	240	120	P-2x150	HC-L
CC-X-300-300	300	300	P-2x200	HC-L
CC-X-300-240	300	240	P-2x250	HC-L

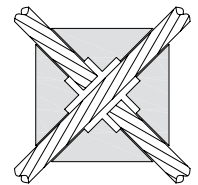



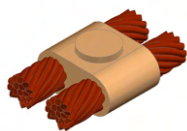

DOUBLE HORIZONTAL (CC-DPH)

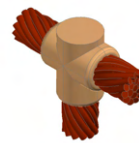

TEE VERTICAL (CC-TV)

**CABLE TO CABLE CONNECTION (DOUBLE HORIZONTAL)**

Conforms to IEC 62561-1 and UL 467

Code	Stranded/Solid Circular Conductor Size (A) (mm <sup>2</sup> )	Stranded/Solid Circular Conductor Size (B) (mm <sup>2</sup> )	Powder	Handle Clamp
CC-DPH-16-16	16	16	P-65	HC-M
CC-DPH-25-25	25	25	P-45	HC-M
CC-DPH-35-35	35	35	P-65	HC-M
CC-DPH-50-50	50	50	P-90	HC-M
CC-DPH-50-35	50	35	P-90	HC-M
CC-DPH-50-25	50	25	P-90	HC-M
CC-DPH-70-70	70	70	P-115	HC-M
CC-DPH-70-50	70	50	P-115	HC-M
CC-DPH-70-35	70	35	P-90	HC-M
CC-DPH-70-25	70	25	P-90	HC-M
CC-DPH-95-95	95	95	P-150	HC-M
CC-DPH-95-70	95	70	P-150	HC-M
CC-DPH-95-50	95	50	P-150	HC-M
CC-DPH-95-35	95	35	P-115	HC-M
CC-DPH-120-120	120	120	P-200	HC-M
CC-DPH-120-95	120	95	P-200	HC-M
CC-DPH-120-70	120	70	P-200	HC-M
CC-DPH-120-50	120	50	P-150	HC-M

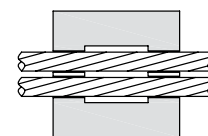

**CABLE TO CABLE CONNECTION (TEE VERTICAL)**

Conforms to IEC 62561-1 and UL 467

Code	Stranded/Solid Circular Conductor Size (A) (mm <sup>2</sup> )	Stranded/Solid Circular Conductor Size (B) (mm <sup>2</sup> )	Powder	Handle Clamp
CC-TV-16-16	16	16	P-45	HC-M
CC-TV-25-25	25	25	P-45	HC-M
CC-TV-35-35	35	35	P-45	HC-M
CC-TV-50-50	50	50	P-90	HC-M
CC-TV-70-70	70	70	P-90	HC-M
CC-TV-70-50	70	50	P-90	HC-M
CC-TV-95-95	95	95	P-115	HC-M
CC-TV-95-70	95	70	P-90	HC-M
CC-TV-95-50	95	50	P-90	HC-M
CC-TV-120-120	120	120	P-150	HC-M
CC-TV-120-95	120	95	P-150	HC-M
CC-TV-120-70	120	70	P-90	HC-M
CC-TV-120-50	120	50	P-90	HC-M
CC-TV-150-150	150	150	P-200	HC-M
CC-TV-150-120	150	120	P-150	HC-M
CC-TV-150-95	150	95	P-150	HC-M
CC-TV-185-185	185	185	P-200	HC-M
CC-TV-185-150	185	150	P-200	HC-M
CC-TV-185-120	185	120	P-200	HC-M
CC-TV-240-240	240	240	P-2x150	HC-M

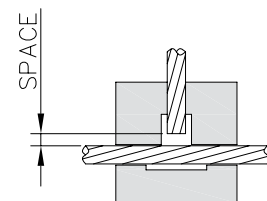



STRAIGHT VERTICAL (CP-V)

**CABLE TO EARTH ROD CONNECTION (Straight Vertical)**

Conforms to IEC 62561-1

Code	EARTH ROD (A) Ø (mm)	EARTH ROD (B) Ø (")	Stranded/Solid Circular Conductor Size (C) (mm <sup>2</sup> )	Powder	Handle Clamp
CP-V-127-16	12.7	1/2	16	P-90	HC-M
CP-V-127-25	12.7	1/2	25	P-90	HC-M
CP-V-127-35	12.7	1/2	35	P-90	HC-M
CP-V-127-50	12.7	1/2	50	P-90	HC-M
CP-V-127-70	12.7	1/2	70	P-90	HC-M
CP-V-127-95	12.7	1/2	95	P-115	HC-M
CP-V-127-120	12.7	1/2	120	P-150	HC-M
CP-V-142-16	14.2	5/8	16	P-90	HC-M
CP-V-142-25	14.2	5/8	25	P-90	HC-M
CP-V-142-35	14.2	5/8	35	P-90	HC-M
CP-V-142-50	14.2	5/8	50	P-90	HC-M
CP-V-142-70	14.2	5/8	70	P-115	HC-M
CP-V-142-95	14.2	5/8	95	P-115	HC-M
CP-V-142-120	14.2	5/8	120	P-150	HC-M
CP-V-142-150	14.2	5/8	150	P-200	HC-M
CP-V-142-185	14.2	5/8	185	P-200	HC-M
CP-V-142-240	14.2	5/8	240	P-250	HC-M
CP-V-172-16	17.2	3/4	16	P-90	HC-M
CP-V-172-25	17.2	3/4	25	P-90	HC-M
CP-V-172-35	17.2	3/4	35	P-90	HC-M
CP-V-172-50	17.2	3/4	50	P-115	HC-M
CP-V-172-70	17.2	3/4	70	P-115	HC-M
CP-V-172-95	17.2	3/4	95	P-115	HC-M
CP-V-172-120	17.2	3/4	120	P-150	HC-M
CP-V-172-150	17.2	3/4	150	P-200	HC-M
CP-V-172-185	17.2	3/4	185	P-200	HC-M
CP-V-172-240	17.2	3/4	240	P-250	HC-M
CP-V-172-300	17.2	3/4	300	P-2x150	HC-L

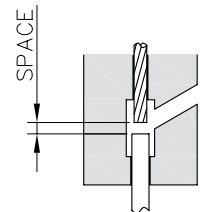

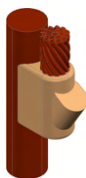

ONE SIDE VERTICAL (CP-VS)

Code	<b>CABLE TO EARTH ROD CONNECTION (One Side Vertical)</b>				
	Conforms to IEC 62561-1				
	EARTH ROD (B) Ø (mm)	EARTH ROD (B) Ø (")	Stranded/Solid Circular Conductor Size (A) (mm <sup>2</sup> )	Powder	Handle Clamp
CP-VS-127-16	12.7	1/2	16	P-90	HC-M
CP-VS-127-25	12.7	1/2	25	P-90	HC-M
CP-VS-127-35	12.7	1/2	35	P-90	HC-M
CP-VS-127-50	12.7	1/2	50	P-90	HC-M
CP-VS-127-70	12.7	1/2	70	P-90	HC-M
CP-VS-127-95	12.7	1/2	95	P-115	HC-M
CP-VS-127-120	12.7	1/2	120	P-150	HC-M
CP-VS-142-16	14.2	5/8	16	P-90	HC-M
CP-VS-142-25	14.2	5/8	25	P-90	HC-M
CP-VS-142-35	14.2	5/8	35	P-90	HC-M
CP-VS-142-50	14.2	5/8	50	P-90	HC-M
CP-VS-142-70	14.2	5/8	70	P-115	HC-M
CP-VS-142-95	14.2	5/8	95	P-115	HC-M
CP-VS-142-120	14.2	5/8	120	P-150	HC-M
CP-VS-142-150	14.2	5/8	150	P-200	HC-M
CP-VS-142-185	14.2	5/8	185	P-200	HC-M
CP-VS-142-240	14.2	5/8	240	P-250	HC-M
CP-VS-172-16	17.2	3/4	16	P-90	HC-M
CP-VS-172-25	17.2	3/4	25	P-90	HC-M
CP-VS-172-35	17.2	3/4	35	P-90	HC-M
CP-VS-172-50	17.2	3/4	50	P-115	HC-M
CP-VS-172-70	17.2	3/4	70	P-115	HC-M
CP-VS-172-95	17.2	3/4	95	P-115	HC-M
CP-VS-172-120	17.2	3/4	120	P-150	HC-M
CP-VS-172-150	17.2	3/4	150	P-200	HC-M
CP-VS-172-185	17.2	3/4	185	P-200	HC-M
CP-VS-172-240	17.2	3/4	240	P-250	HC-M
CP-VS-172-300	17.2	3/4	300	P-2x150	HC-L

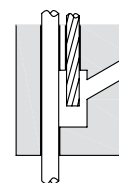

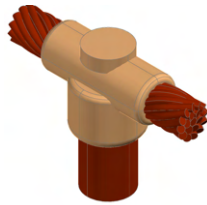

TEE TYPE (CP-T)

Code	<b>CABLE TO EARTH ROD (T-Type)</b>				
	Conforms to IEC 62561-1				
	EARTH ROD (B) Ø (mm)	EARTH ROD (B) Ø (")	Stranded/Solid Circular Conductor Size (A) (mm <sup>2</sup> )	Powder	Handle Clamp
CP-T-127-16	12.7	1/2	16	P-90	HC-M
CP-T-127-25	12.7	1/2	25	P-90	HC-M
CP-T-127-35	12.7	1/2	35	P-90	HC-M
CP-T-127-50	12.7	1/2	50	P-90	HC-M
CP-T-127-70	12.7	1/2	70	P-90	HC-M
CP-T-127-95	12.7	1/2	95	P-115	HC-M
CP-T-127-120	12.7	1/2	120	P-150	HC-M
CP-T-142-16	14.2	5/8	16	P-90	HC-M
CP-T-142-25	14.2	5/8	25	P-90	HC-M
CP-T-142-35	14.2	5/8	35	P-90	HC-M
CP-T-142-50	14.2	5/8	50	P-90	HC-M
CP-T-142-70	14.2	5/8	70	P-115	HC-M
CP-T-142-95	14.2	5/8	95	P-115	HC-M
CP-T-142-120	14.2	5/8	120	P-150	HC-M
CP-T-142-150	14.2	5/8	150	P-200	HC-M
CP-T-142-185	14.2	5/8	185	P-200	HC-M
CP-T-142-240	14.2	5/8	240	P-250	HC-M
CP-T-172-16	17.2	3/4	16	P-90	HC-M
CP-T-172-25	17.2	3/4	25	P-90	HC-M
CP-T-172-35	17.2	3/4	35	P-90	HC-M
CP-T-172-50	17.2	3/4	50	P-115	HC-M
CP-T-172-70	17.2	3/4	70	P-115	HC-M
CP-T-172-95	17.2	3/4	95	P-115	HC-M
CP-T-172-120	17.2	3/4	120	P-150	HC-M
CP-T-172-150	17.2	3/4	150	P-200	HC-M
CP-T-172-185	17.2	3/4	185	P-200	HC-M
CP-T-172-240	17.2	3/4	240	P-250	HC-M
CP-T-172-300	17.2	3/4	300	P-2x150	HC-L

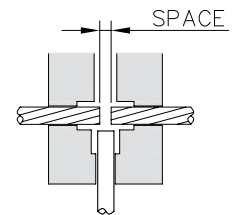



ONE SIDE HORIZONTAL (CP-AR)

Code	<b>CABLE TO EARTH ROD (L-Type)</b>				
	Conforms to IEC 62561-1				
	EARTH ROD (B) Ø (mm)	EARTH ROD (B) Ø (")	Stranded/Solid Circular Conductor Size (A) (mm <sup>2</sup> )	Powder	Handle Clamp
CP-AR-127-16	12.7	1/2	16	P-65	HC-M
CP-AR-127-25	12.7	1/2	25	P-65	HC-M
CP-AR-127-35	12.7	1/2	35	P-65	HC-M
CP-AR-127-50	12.7	1/2	50	P-65	HC-M
CP-AR-127-70	12.7	1/2	70	P-90	HC-M
CP-AR-127-95	12.7	1/2	95	P-90	HC-M
CP-AR-127-120	12.7	1/2	120	P-90	HC-M
CP-AR-142-16	14.2	5/8	16	P-65	HC-M
CP-AR-142-25	14.2	5/8	25	P-65	HC-M
CP-AR-142-35	14.2	5/8	35	P-65	HC-M
CP-AR-142-50	14.2	5/8	50	P-90	HC-M
CP-AR-142-70	14.2	5/8	70	P-90	HC-M
CP-AR-142-95	14.2	5/8	95	P-90	HC-M
CP-AR-142-120	14.2	5/8	120	P-90	HC-M
CP-AR-142-150	14.2	5/8	150	P-115	HC-M
CP-AR-142-185	14.2	5/8	185	P-115	HC-M
CP-AR-142-240	14.2	5/8	240	P-150	HC-M
CP-AR-172-16	17.2	3/4	16	P-65	HC-M
CP-AR-172-25	17.2	3/4	25	P-65	HC-M
CP-AR-172-35	17.2	3/4	35	P-65	HC-M
CP-AR-172-50	17.2	3/4	50	P-90	HC-M
CP-AR-172-70	17.2	3/4	70	P-90	HC-M
CP-AR-172-95	17.2	3/4	95	P-90	HC-M
CP-AR-172-120	17.2	3/4	120	P-90	HC-M
CP-AR-172-150	17.2	3/4	150	P-115	HC-M
CP-AR-172-185	17.2	3/4	185	P-115	HC-M
CP-AR-172-240	17.2	3/4	240	P-150	HC-M
CP-AR-172-300	17.2	3/4	300	P-200	HC-M

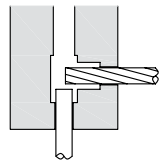

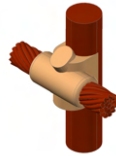

CROSS SIDE HORIZONTAL (CP-TS)



VERTICAL PARALLEL (PP-V)

**CABLE TO EARTH ROD (CROSS SIDE HORIZONTAL)**

Conforms to IEC 62561-1

Code	EARTH ROD (B) Ø (mm)	EARTH ROD (B) Ø (")	Stranded/Solid Circular Conductor Size (A) (mm <sup>2</sup> )	Powder	Handle Clamp
CP-TS-127-16	12.7	1/2	16	P-90	HC-M
CP-TS-127-25	12.7	1/2	25	P-90	HC-M
CP-TS-127-35	12.7	1/2	35	P-90	HC-M
CP-TS-127-50	12.7	1/2	50	P-115	HC-M
CP-TS-127-70	12.7	1/2	70	P-115	HC-M
CP-TS-127-95	12.7	1/2	95	P-115	HC-M
CP-TS-127-120	12.7	1/2	120	P-150	HC-M
CP-TS-142-16	14.2	5/8	16	P-90	HC-M
CP-TS-142-25	14.2	5/8	25	P-90	HC-M
CP-TS-142-35	14.2	5/8	35	P-90	HC-M
CP-TS-142-50	14.2	5/8	50	P-115	HC-M
CP-TS-142-70	14.2	5/8	70	P-115	HC-M
CP-TS-142-95	14.2	5/8	95	P-115	HC-M
CP-TS-142-120	14.2	5/8	120	P-150	HC-M
CP-TS-142-150	14.2	5/8	150	P-150	HC-M
CP-TS-142-185	14.2	5/8	185	P-200	HC-M
CP-TS-142-240	14.2	5/8	240	P-2x200	HC-M
CP-TS-172-16	17.2	3/4	16	P-90	HC-M
CP-TS-172-25	17.2	3/4	25	P-90	HC-M
CP-TS-172-35	17.2	3/4	35	P-90	HC-M
CP-TS-172-50	17.2	3/4	50	P-115	HC-M
CP-TS-172-70	17.2	3/4	70	P-150	HC-M
CP-TS-172-95	17.2	3/4	95	P-150	HC-M
CP-TS-172-120	17.2	3/4	120	P-200	HC-M
CP-TS-172-150	17.2	3/4	150	P-250	HC-M
CP-TS-172-185	17.2	3/4	185	P-2x200	HC-L
CP-TS-172-240	17.2	3/4	240	P-2x250	HC-L
CP-TS-172-300	17.2	3/4	300	P-3x200	HC-L

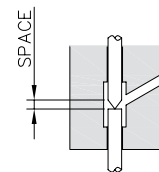
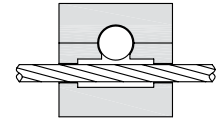

Leave a space of 5-6mm on cable and rod. Clamp the rod so it will not move.

PP-V (ROD TO ROD CONNECTION)	
143	P-200
146	P-200
58	P-200
183	P-150 x 2
34	P-150 x 2

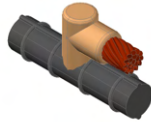

Cable to Reinforcing bar (CR-TP)



Cable to Reinforcing bar (CR-PH)



Cable to Reinforcing bar (CR-TL)

<b>CABLE TO REINFORCING BAR (Single Parallel)</b>				
<b>Conforms to IEC 62561-1</b>				
<b>Code</b>	<b>Reinforcing bar Size (A) Ø (mm)</b>	<b>Stranded/Solid Circular Conductor Size (B) (mm<sup>2</sup>)</b>	<b>Powder</b>	<b>Handle Clamp</b>
CR-TP-16	10-40	16	P-45	HC-M
CR-TP-25	10-40	25	P-45	HC-M
CR-TP-35	10-40	35	P-45	HC-M
CR-TP-50	10-40	50	P-90	HC-M
CR-TP-70	10-40	70	P-90	HC-M
CR-TP-95	10-40	95	P-90	HC-M
CR-TP-120	10-40	120	P-90	HC-M

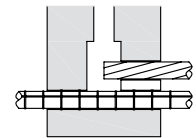

<b>CABLE TO REINFORCING BAR (Cross Side Horizontal)</b>				
<b>Conforms to IEC 62561-1</b>				
	<b>Reinforcing bar Size (A) Ø (mm)</b>	<b>Stranded/Solid Circular Conductor Size (B) (mm<sup>2</sup>)</b>	<b>Powder</b>	<b>Handle Clamp</b>
CR-PH-16	10-40	16	P-45	HC-M
CR-PH-25	10-40	25	P-45	HC-M
CR-PH-35	10-40	35	P-45	HC-M
CR-PH-50	10-40	50	P-90	HC-M
CR-PH-70	10-40	70	P-90	HC-M
CR-PH-95	10-40	95	P-90	HC-M
CR-PH-120	10-40	120	P-90	HC-M

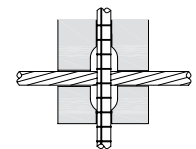

<b>CABLE TO REINFORCING BAR (Tee Vertical)</b>				
<b>Conforms to IEC 62561-1</b>				
	<b>Reinforcing bar Size (A) Ø (mm)</b>	<b>Stranded/Solid Circular Conductor Size (B) (mm<sup>2</sup>)</b>	<b>Powder</b>	<b>Handle Clamp</b>
CR-TL-16	10-40	16	P-45	HC-M
CR-TL-25	10-40	25	P-45	HC-M
CR-TL-35	10-40	35	P-45	HC-M
CR-TL-50	10-40	50	P-65	HC-M
CR-TL-70	10-40	70	P-90	HC-M
CR-TL-95	10-40	95	P-90	HC-M
CR-TL-120	10-40	120	P-115	HC-M

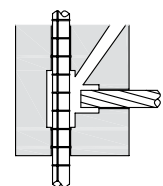



Cable to Reinforcing bar (CR-TH)

<b>CABLE TO REINFORCING BAR (CR-TH)</b>									
<b>Code</b>	<b>Conforms to IEC 62561-1</b>								
	<b>Reinforcing Bar Size (A) Ø (mm)</b>	<b>Stranded/ Solid Circular Conductor Size (B) (mm<sup>2</sup>)</b>	<b>Powder</b>	<b>Handle Clamp</b>		<b>Reinforcing Bar Size (A) Ø (mm)</b>	<b>Stranded/ Solid Circular Conductor Size (B) (mm<sup>2</sup>)</b>	<b>Powder</b>	<b>Handle Clamp</b>
CR-TH-16-H16	16	16	P-90	HC-M	CR-TH-20-H150	20	150	P-200	HC-M
CR-TH-16-H25	16	25	P-90	HC-M	CR-TH-20-H150	20	185	P-200	HC-M
CR-TH-16-H35	16	35	P-90	HC-M	CR-TH-20-H240	20	240	P-2x150	HC-M
CR-TH-16-H50	16	50	P-115	HC-M	CR-TH-20-H300	20	300	P-2x200	HC-M
CR-TH-16-H70	16	70	P-115	HC-M	CR-TH-25-H16	25	16	P-200	HC-M
CR-TH-16-H95	16	95	P-150	HC-M	CR-TH-25-H25	25	25	P-200	HC-M
CR-TH-16-H120	16	120	P-150	HC-M	CR-TH-25-H35	25	35	P-200	HC-M
CR-TH-16-H150	16	150	P-200	HC-M	CR-TH-25-H50	25	50	P-200	HC-M
CR-TH-16-H185	16	185	P-200	HC-M	CR-TH-25-H70	25	70	P-250	HC-M
CR-TH-16-H240	16	240	P-250	HC-M	CR-TH-25-H95	25	95	P-250	HC-M
CR-TH-16-H300	16	300	P-2x150	HC-M	CR-TH-25-H120	25	120	P-250	HC-M
CR-TH-18-H16	18	16	P-115	HC-M	CR-TH-25-H150	25	150	P-2x150	HC-M
CR-TH-18-H25	18	25	P-115	HC-M	CR-TH-25-H185	25	185	P-2x150	HC-L
CR-TH-18-H35	18	35	P-115	HC-M	CR-TH-25-H240	25	240	P-2x200	HC-L
CR-TH-18-H50	18	50	P-150	HC-M	CR-TH-25-H300	25	300	P-2x200	HC-L
CR-TH-18-H70	18	70	P-150	HC-M	CR-TH-30-H16	30	16	P-250	HC-M
CR-TH-18-H95	18	95	P-150	HC-M	CR-TH-30-H25	30	25	P-250	HC-M
CR-TH-18-H120	18	120	P-200	HC-M	CR-TH-30-H35	30	35	P-250	HC-M
CR-TH-18-H150	18	150	P-200	HC-M	CR-TH-30-H50	30	50	P-2x150	HC-M
CR-TH-18-H185	18	185	P-200	HC-M	CR-TH-30-H70	30	70	P-2x150	HC-M
CR-TH-18-H240	18	240	P-250	HC-M	CR-TH-30-H95	30	95	P-2x150	HC-L
CR-TH-18-H300	18	300	P-2x150	HC-M	CR-TH-30-H120	30	120	P-2x200	HC-L
CR-TH-20-H16	20	16	P-115	HC-M	CR-TH-30-H150	30	150	P-2x200	HC-L
CR-TH-20-H25	20	25	P-115	HC-M	CR-TH-30-H185	30	185	P-2x250	HC-L
CR-TH-20-H35	20	35	P-115	HC-M	CR-TH-30-H240	30	240	P-3x200	HC-L
CR-TH-20-H50	20	50	P-150	HC-M					
CR-TH-20-H70	20	70	P-200	HC-M					
CR-TH-20-H95	20	95	P-200	HC-M					
CR-TH-20-H120	20	120	P-200	HC-M					

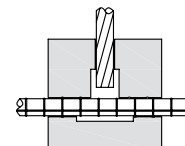



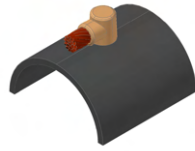

SINGLE PIPE HORIZONTAL (CT-TH)

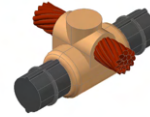

HORIZONTAL CROSS TAP (CR-XS)

**Code** **CABLE TO STEEL SURFACE & PIPE CT-TH (SINGLE HORIZONTAL)**

Conforms to IEC 62561-1

Code	Stranded/Solid Circular Conductor Size (A) (mm <sup>2</sup> )	Pipe Size (B) Ø (mm)	Powder	Handle Clamp
CT-TH-2.5A	2.5	<125	P-15	HC-M
CT-TH-2.5B	2.5	>125	P-15	HC-M
CT-TH-4A	4	<125	P-15	HC-M
CT-TH-4B	4	>125	P-15	HC-M
CT-TH-6A	6	<125	P-15	HC-M
CT-TH-6B	6	>125	P-15	HC-M
CT-TH-10A	10	<125	P-25	HC-M
CT-TH-10B	10	>125	P-25	HC-M
CT-TH-16A	16	<125	P-45	HC-L
CT-TH-16B	16	>125	P-45	HC-L
CT-TH-25A	25	<70	P-25	HC-M
CT-TH-25B	25	70-165	P-25	HC-M
CT-TH-25C	25	>165	P-25	HC-M
CT-TH-35A	35	<70	P-45	HC-L
CT-TH-35B	35	70-165	P-45	HC-L
CT-TH-35C	35	165-250	P-45	HC-L
CT-TH-35D	35	>250	P-45	HC-L
CT-TH-50A	50	<70	P-45	HC-L
CT-TH-50B	50	70-165	P-45	HC-L
CT-TH-50C	50	165-250	P-45	HC-L
CT-TH-50D	50	>250	P-45	HC-L
CT-TH-70A	70	<70	P-65	HC-L
CT-TH-70B	70	70-165	P-65	HC-L
CT-TH-70C	70	165-250	P-65	HC-L
CT-TH-50D	70	>250	P-65	HC-L

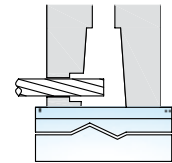

**Code** **CABLE TO REINFORCING BAR (CR-XS)**

Code	Reinforcing bar Size (A) Ø (mm)	Stranded/Solid Circular Conductor Size (B) (mm <sup>2</sup> )	Powder	Handle Clamp
CR-XS-1650	16	50	P-150	HC-L
CR-XS-1670	16	70	P-150	HC-L
CR-XS-16120	16	120	P-200	HC-L
CR-XS-16150	16	150	P-200	HC-L
CR-XS-2070	20	70	P-150	HC-L
CR-XS-2095	20	95	P-200	HC-L
CR-XS-20185	20	185	P-250	HC-L
CR-XS-20240	20	240	P-150 x 2	HC-L

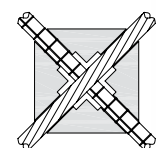



STRAIGHT INCLINED (CH-TF)



SINGLE DESCENDING (CH-VI)

**Code** **CABLE TO STEEL SURFACE & PIPE CH-TF (STRAIGHT INCLINED)**

Conforms to IEC 62561-1

Code	Stranded/Solid Circular Conductor Size (A) (mm <sup>2</sup> )	Powder	Handle Clamp
CH-TF-16	16	P-45	HC-M
CH-TF-25	25	P-45	HC-M
CH-TF-35	35	P-45	HC-M
CH-TF-50	50	P-65	HC-M
CH-TF-70	70	P-90	HC-M
CH-TF-95	95	P-115	HC-M
CH-TF-120	120	P-115	HC-M
CH-TF-150	150	P-115	HC-M
CH-TF-185	185	P-200	HC-M
CH-TF-240	240	P-200	HC-M
CH-TF-300	300	P-250	HC-M

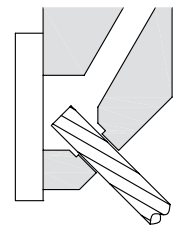

**CABLE TO STEEL SURFACE & PIPE CH-VI (SINGLE DESCENDING)**

Conforms to IEC 62561-1

Code	Stranded/Solid Circular Conductor Size (A) (mm <sup>2</sup> )	Powder	Handle Clamp
CH-VI-16	16	P-45	HC-M
CH-VI-25	25	P-45	HC-M
CH-VI-35	35	P-45	HC-M
CH-VI-50	50	P-65	HC-M
CH-VI-70	70	P-90	HC-M
CH-VI-95	95	P-115	HC-M
CH-VI-120	120	P-115	HC-M
CH-VI-150	150	P-150	HC-M
CH-VI-185	185	P-200	HC-M
CH-VI-240	240	P-200	HC-M
CH-VI-300	300	P-250	HC-M

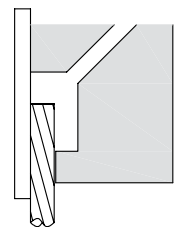

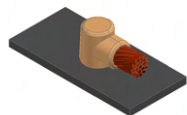

SINGLE HORIZONTAL (CH-TH)

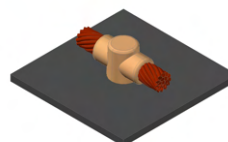

DOUBLE HORIZONTAL (CH-PPH)

**Code** **CABLE TO STEEL SURFACE & PIPE CH-TH (SINGLE HORIZONTAL)**

Conforms to IEC 62561-1

Code	Stranded/Solid Circular Conductor Size (A) (mm <sup>2</sup> )	Powder	Handle Clamp
CH-TH-16	16	P-45	HC-M
CH-TH-25	25	P-45	HC-M
CH-TH-35	35	P-45	HC-M
CH-TH-50	50	P-45	HC-M
CH-TH-70	70	P-65	HC-M
CH-TH-95	95	P-90	HC-M
CH-TH-120	120	P-115	HC-L
CH-TH-150	150	P-150	HC-L
CH-TH-185	185	P-200	HC-L
CH-TH-240	240	P-200	HC-L
CH-TH-300	300	P-250	HC-L

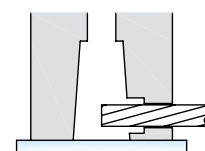

**CABLE TO STEEL SURFACE & PIPE CH-PPH (DOUBLE HORIZONTAL)**

Conforms to IEC 62561-1

Code	Stranded/Solid Circular Conductor Size (A) (mm <sup>2</sup> )	Powder	Handle Clamp
CH-PPH-16	16	P-45	HC-M
CH-PPH-25	25	P-45	HC-M
CH-PPH-35	35	P-45	HC-M
CH-PPH-50	50	P-90	HC-M
CH-PPH-70	70	P-115	HC-M
CH-PPH-95	95	P-115	HC-M
CH-PPH-120	120	P-150	HC-M
CH-PPH-150	150	P-200	HC-M
CH-PPH-185	185	P-250	HC-M
CH-PPH-240	240	P-2x150	HC-M
CH-PPH-300	300	P-250	HC-L

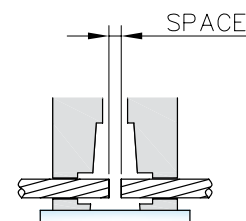

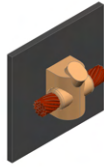

DOUBLE VERTICAL-(CH-TVD/CH-TVI)



SINGLE ASCENDING (CH-VS)

**Code** **CABLE TO STEEL SURFACE & PIPE CH-TVD/CH-TVI (DOUBLE VERTICAL)**

Conforms to IEC 62561-1

Code	Stranded/Solid Circular Conductor Size (A) (mm <sup>2</sup> )	Powder	Handle Clamp
CH-TVD-16	16	P-45	HC-M
CH-TVD-25	25	P-45	HC-M
CH-TVD-35	35	P-45	HC-M
CH-TVD-50	50	P-65	HC-M
CH-TVD-70	70	P-115	HC-M
CH-TVD-95	95	P-150	HC-M
CH-TVD-120	120	P-150	HC-M
CH-TVD-150	150	P-200	HC-L
CH-TVD-185	185	P-250	HC-L
CH-TVD-240	240	P-2x150	HC-L
CH-TVD-300	300	P-2x200	HC-L

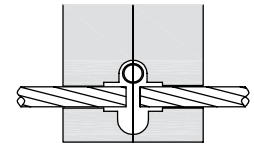

**CABLE TO STEEL SURFACE & PIPE CH-VS (SINGLE ASCENDING)**

Conforms to IEC 62561-1

Code	Stranded/Solid Circular Conductor Size (A) (mm <sup>2</sup> )	Powder	Handle Clamp
CH-VS-16	16	P-65	HC-M
CH-VS-25	25	P-65	HC-M
CH-VS-35	35	P-65	HC-M
CH-VS-50	50	P-90	HC-M
CH-VS-70	70	P-150	HC-M
CH-VS-95	95	P-200	HC-M
CH-VS-120	120	P-200	HC-M
CH-VS-150	150	P-250	HC-M
CH-VS-185	185	P-2x150	HC-M
CH-VS-240	240	P-2x150	HC-M
CH-VS-300	300	P-2x200	HC-L

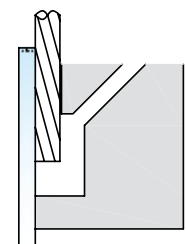



VERTICAL PARALLEL (CH-PVV)



ONE SIDE SINGLE (CH-PVH)

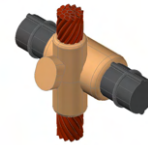

CROSS VERTICAL (CR-PV)

**Code** **CABLE TO STEEL SURFACE & PIPE CH-PVV (VERTICAL PARALLEL)**

Conforms to IEC 62561-1

Code	Stranded/Solid Circular Conductor Size (A) (mm <sup>2</sup> )	Powder	Handle Clamp
CH-PVV-16	16	P-45	HC-M
CH-PVV-25	25	P-45	HC-M
CH-PVV-35	35	P-45	HC-M
CH-PVV-50	50	P-90	HC-M
CH-PVV-70	70	P-115	HC-M
CH-PVV-95	95	P-115	HC-M
CH-PVV-120	120	P-150	HC-M
CH-PVV-150	150	P-200	HC-M
CH-PVV-185	185	P-250	HC-M
CH-PVV-240	240	P-150x2	HC-L
CH-PVV-300	300	P-200x2	HC-L

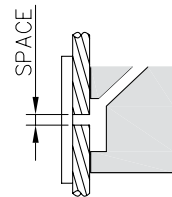

**Code** **CABLE TO STEEL SURFACE & PIPE CH-PVH (ONE SIDE SINGLE)**

Code	Stranded/Solid Circular Conductor Size (A) (mm <sup>2</sup> )	Powder	Handle Clamp
CH-PVH-25	25	P-65	HC-M
CH-PVH-35	35	P-90	HC-M
CH-PVH-50	50	P-115	HC-M
CH-PVH-70	70	P-115	HC-M
CH-PVH-95	95	P-150	HC-M
CH-PVH-120	120	P-150	HC-M
CH-PVH-150	150	P-200	HC-M
CH-PVH-185	185	P-250	HC-M
CH-PVH-240	240	P-150 x2	HC-M

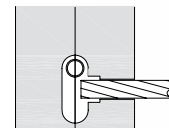

**Code** **CABLE TO REINFORCING BAR (CR-PV)**

Code	Reinforcing bar Size (A) Ø (mm)	Stranded/Solid Circular Conductor Size (B) (mm <sup>2</sup> )	Powder	Handle Clamp
CR-PV-1650	16	50	P-150	HC-M
CR-PV-1670	16	70	P-150	HC-M
CR-PV-16120	16	120	P-200	HC-M
CR-PV-16150	16	150	P-200	HC-M
CR-PV-2070	20	70	P-150	HC-M
CR-PV-2095	20	95	P-200	HC-M
CR-PV-20185	20	185	P-250	HC-M
CR-PV-20240	20	240	P-150 x 2	HC-M

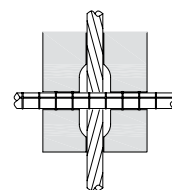

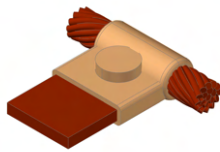

TEE HORIZONTAL (CPL-T)

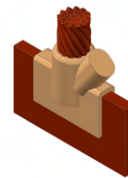

TEE VERTICAL (CPL-VS)

Code	CABLE TO BAR (CPL - T)			
	Conforms to IEC 62561-1			
	Stranded/Solid Circular Conductor Size (A) (mm <sup>2</sup> )	Flat Tape Conductor Size (B) (mm)	Powder	Handle Clamp
CPL-T-16-203	16	20x3	P-45	HC-M
CPL-T-16-253	16	25x3	P-65	HC-M
CPL-T-25-203	25	20x3	P-45	HC-M
CPL-T-25-253	25	25x3	P-65	HC-M
CPL-T-35-203	35	20x3	P-45	HC-M
CPL-T-35-253	35	25x3	P-65	HC-M
CPL-T-50-203	50	20x3	P-65	HC-M
CPL-T-50-253	50	25x3	P-65	HC-M
CPL-T-70-254	70	25x4	P-90	HC-M
CPL-T-70-256	70	25x6	P-115	HC-M
CPL-T-70-253	70	25x3	P-115	HC-M
CPL-T-95-254	95	25x4	P-150	HC-M
CPL-T-95-256	95	25x6	P-150	HC-M
CPL-T-120-254	120	25x4	P-150	HC-M
CPL-T-120-256	120	25x6	P-200	HC-M
CPL-T-150256	150	25x6	P-200	HC-M
CPL-T-150305	150	30x5	P-200	HC-M
CPL-T-150-405	150	40x5	P-250	HC-M
CPL-T-185-316	185	31x6	P-250	HC-M
CPL-T-185-405	185	40x5	P-250	HC-M
CPL-T-185-505	185	50x5	P-2x150	HC-L
CPL-T-240-505	240	50x5	P-2x150	HC-L
CPL-T-240-506	240	50x6	P-2x200	HC-L
CPL-T-300-506	300	50x6	P-2x250	HC-L

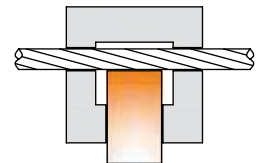

Code	CABLE TO BAR (CPL - VS)			
	Stranded/Solid Circular Conductor Size (B) (mm <sup>2</sup> )	Flat Tape Conductor Size (A) (mm)	Powder	Handle Clamp
CPL-VS-25-253	25	25x3	P-90	HC-M
CPL-VS-35-253	35	25x3	P-90	HC-M
CPL-VS-50-253	50	25x3	P-115	HC-M
CPL-VS-70-253	70	25x3	P-115	HC-M
CPL-VS-95-253	95	25x3	P-150	HC-M
CPL-VS-120-305	120	30x5	P-200	HC-M
CPL-VS-150-405	150	40x5	P-250	HC-M
CPL-VS-240-505	240	50x5	P-150 x 2	HC-M

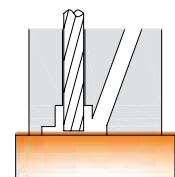

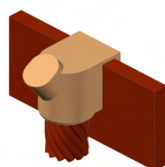

TEE DESCENDING (CPL-VI)

Code	<b>CABLE TO BAR (TEE TYPE)</b>			
	Conforms to IEC 62561-1			
	Stranded/Solid Circular Conductor Size (B) (mm <sup>2</sup> )	Flat Tape Conductor Size (A) (mm)	Powder	Handle Clamp
CPL-VI-16-203	16	20x3	P-45	HC-M
CPL-VI-16-253	16	25x3	P-45	HC-M
CPL-VI-25-203	25	20x3	P-45	HC-M
CPL-VI-25-253	25	25x3	P-45	HC-M
CPL-VI-35-203	35	20x3	P-45	HC-M
CPL-VI-35-253	35	25x3	P-45	HC-M
CPL-VI-50-203	50	20x3	P-45	HC-M
CPL-VI-50-253	50	25x3	P-45	HC-M
CPL-VI-70-254	70	25x4	P-65	HC-M
CPL-VI-70-256	70	25x6	P-65	HC-M
CPL-VI-70-253	70	25x3	P-90	HC-M
CPL-VI-95-254	95	25x4	P-90	HC-M
CPL-VI-95-256	95	25x6	P-115	HC-M
CPL-VI-120-254	120	25x4	P-115	HC-M
CPL-VI-120-256	120	25x6	P-115	HC-M
CPL-VI-150-256	150	25x6	P-115	HC-M
CPL-VI-150-305	150	30x5	P-115	HC-M
CPL-VI-150-405	150	40x5	P-115	HC-M
CPL-VI-185-316	185	31x6	P-150	HC-M
CPL-VI-185-405	185	40x5	P-150	HC-M
CPL-VI-185-505	185	50x5	P-150	HC-M
CPL-VI-240-505	240	50x5	P-200	HC-M
CPL-VI-240-506	240	50x6	P-250	HC-M
CPL-VI-300-506	300	50x6	P-2x150	HC-L

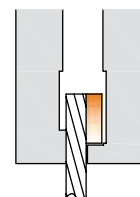

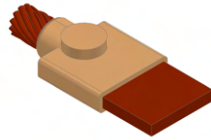

STRAIGHT WIDTH (CPL-L)

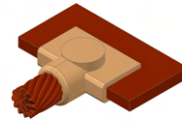

TAPE TEE HORIZONTAL (CPL-H)

<b>CABLE TO BAR (STRAIGHT WIDTH)</b>				
<b>Code</b>	<b>Conforms to IEC 62561-1</b>			
	<b>Stranded/Solid Circular Conductor Size (B) (mm<sup>2</sup>)</b>	<b>Flat Tape Conductor Size (A) (mm)</b>	<b>Powder</b>	<b>Handle Clamp</b>
CPL-L-16-203	16	20x3	P-45	HC-M
CPL-L-16-253	16	25x3	P-45	HC-M
CPL-L-25-203	25	20x3	P-32	HC-M
CPL-L-25-253	25	25x3	P-45	HC-M
CPL-L-35-203	35	20x3	P-45	HC-M
CPL-L-35-253	35	25x3	P-45	HC-M
CPL-L-50-203	50	20x3	P-45	HC-M
CPL-L-50-253	50	25x3	P-65	HC-M
CPL-L-70-254	70	25x4	P-65	HC-M
CPL-L-70-256	70	25x6	P-65	HC-M
CPL-L-70-253	70	25x3	P-65	HC-M
CPL-L-95-254	95	25x4	P-90	HC-M
CPL-L-95-256	95	25x6	P-90	HC-M
CPL-L-120-254	120	25x4	P-90	HC-M
CPL-L-120-256	120	25x6	P-115	HC-M
CPL-L-150-256	150	25x6	P-115	HC-M
CPL-L-150-305	150	30x5	P-115	HC-M
CPL-L-150-405	150	40x5	P-150	HC-M
CPL-L-185-316	185	31x6	P-150	HC-M
CPL-L-185-405	185	40x5	P-150	HC-M
CPL-L-185-505	185	50x5	P-200	HC-L
CPL-L-240-505	240	50x5	P-200	HC-L
CPL-L-240-506	240	50x6	P-2x150	HC-L
CPL-L-300-506	300	50x6	P-2x150	HC-L

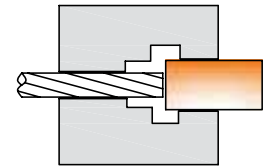

<b>CABLE TO BAR (CPL - H)</b>				
<b>Code</b>	<b>Stranded /Solid Circular Conductor Size (A) (mm<sup>2</sup>)</b>	<b>Flat Tape Conductor Size (B) (mm)</b>	<b>Powder</b>	<b>Handle Clamp</b>
CPL-H-25-203	25	20x3	P-45	HC-M
CPL-H-35-253	35	25x3	P-45	HC-M
CPL-H-50-253	50	25x3	P-65	HC-M
CPL-H-70-253	70	25x3	P-90	HC-M
CPL-H-95-253	95	25x3	P-90	HC-M
CPL-H-120-253	120	25x3	P-115	HC-M
CPL-H-150-253	150	20x3	P-115	HC-M
CPL-H-240-505	240	50x5	P-250	HC-M

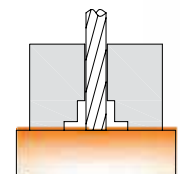



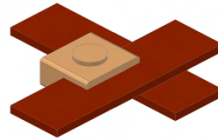

CROSS HORIZONTAL (PL-X)

Code	BAR TO BAR (CROSS)			
	Conforms to IEC 62561-1			
	Flat Tape Conductor Size (A) (mm)	Flat Tape Conductor Size (B) (mm)	Powder	Handle Clamp
PL-X-203-203	20x3	20x3	P-65	HC-M
PL-X-253-253	25x3	25x3	P-65	HC-M
PL-X-254-254	25x4	25x4	P-90	HC-M
PL-X-256-256	25x6	25x6	P-115	HC-M
PL-X-302-302	30x2	30x2	P-65	HC-M
PL-X-303-303	30x3	30x3	P-115	HC-M
PL-X-304-304	30x4	30x4	P-115	HC-M
PL-X-305-305	30x5	30x5	P-115	HC-M
PL-X-313-313	31x3	31x3	P-115	HC-M
PL-X-316-316	31x6	31x6	P-115	HC-M
PL-X-383-383	38x3	38x3	P-150	HC-M
PL-X-385-385	38x5	38x5	P-150	HC-M
PL-X-386-386	38x6	38x6	P-200	HC-M
PL-X-403-403	40x3	40x3	P-200	HC-M
PL-X-404-404	40x4	40x4	P-200	HC-M
PL-X-405-405	40x5	40x5	P-200	HC-M
PL-X-406-406	40x6	40x6	P-200	HC-M
PL-X-503-503	50x3	50x3	P-200	HC-L
PL-X-504-504	50x4	50x4	P-200	HC-L
PL-X-505-505	50x5	50x5	P-200	HC-L
PL-X-506-506	50x6	50x6	P-200	HC-L

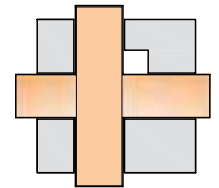

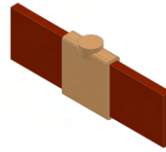

STRAIGHT HEIGHT (PL-LV)

Code	BAR TO BAR (STRAIGHT TYPE)		
	Conforms to IEC 62561-1		
	Flat Tape Conductor Size (A) (mm)	Powder	Handle Clamp
PL-LV-203	20x3	P-45	HC-M
PL-LV-253	25x3	P-65	HC-M
PL-LV-254	25x4	P-90	HC-M
PL-LV-256	25x6	P-150	HC-M
PL-LV-302	30x2	P-65	HC-M
PL-LV-303	30x3	P-90	HC-M
PL-LV-304	30x4	P-115	HC-M
PL-LV-305	30x5	P-115	HC-M
PL-LV-313	31x3	P-90	HC-M
PL-LV-316	31x6	P-150	HC-M
PL-LV-383	38x3	P-115	HC-M
PL-LV-385	38x5	P-150	HC-M
PL-LV-386	38x6	P-200	HC-M
PL-LV-403	40x3	P-115	HC-M
PL-LV-404	40x4	P-150	HC-M
PL-LV-405	40x5	P-150	HC-M
PL-LV-406	40x6	P-200	HC-M
PL-LV-503	50x3	P-150	HC-M
PL-LV-504	50x4	P-200	HC-M
PL-LV-505	50x5	P-200	HC-M
PL-LV-506	50x6	P-250	HC-M

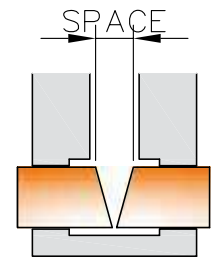

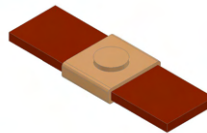

STRAIGHT WIDTH (PL-LH)

Code	<b>BAR TO BAR (STRAIGHT WIDTH TYPE)</b>		
	<b>Conforms to IEC 62561-1</b>		
	Flat Tape Conductor Size (A) (mm)	Powder	Handle Clamp
PL-LH-203	20x3	P-45	HC-M
PL-LH-253	25x3	P-65	HC-M
PL-LH-254	25x4	P-90	HC-M
PL-LH-256	25x6	P-115	HC-M
PL-LH-302	30x2	P-65	HC-M
PL-LH-303	30x3	P-65	HC-M
PL-LH-304	30x4	P-90	HC-M
PL-LH-305	30x5	P-115	HC-M
PL-LH-313	31x3	P-65	HC-M
PL-LH-316	31x6	P-150	HC-M
PL-LH-383	38x3	P-90	HC-M
PL-LH-385	38x5	P-150	HC-M
PL-LH-386	38x6	P-200	HC-M
PL-LH-403	40x3	P-90	HC-M
PL-LH-404	40x4	P-115	HC-M
PL-LH-405	40x5	P-150	HC-M
PL-LH-406	40x6	P-200	HC-M
PL-LH-503	50x3	P-150	HC-L
PL-LH-504	50x4	P-200	HC-L
PL-LH-505	50x5	P-200	HC-L
PL-LH-506	50x6	P-250	HC-L

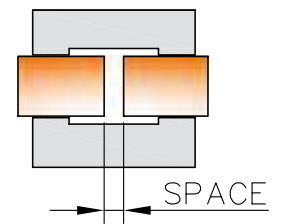

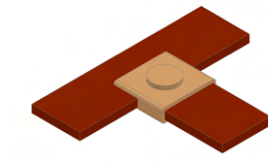

TEE HORIZONTAL (PL-TH)

Code	BAR TO BAR (TEE TYPE)			
	Conforms to IEC 62561-1			
	Flat Tape Conductor Size (A) (mm)	Flat Tape Conductor Size (B) (mm)	Powder	Handle Clamp
PL-TH-203-203	20x3	20x3	P-45	HC-M
PL-TH-253-253	25x3	25x3	P-65	HC-M
PL-TH-254-254	25x4	25x4	P-90	HC-M
PL-TH-256-256	25x6	25x6	P-150	HC-M
PL-TH-302-302	30x2	30x2	P-65	HC-M
PL-TH-303-303	30x3	30x3	P-90	HC-M
PL-TH-304-304	30x4	30x4	P-115	HC-M
PL-TH-305-305	30x5	30x5	P-115	HC-M
PL-TH-313-313	31x3	31x3	P-90	HC-M
PL-TH-316-316	31x6	31x6	P-150	HC-M
PL-TH-383-383	38x3	38x3	P-115	HC-M
PL-TH-385-385	38x5	38x5	P-150	HC-M
PL-TH-386-386	38x6	38x6	P-200	HC-M
PL-TH-403-403	40x3	40x3	P-115	HC-M
PL-TH-404-404	40x4	40x4	P-150	HC-M
PL-TH-405-405	40x5	40x5	P-150	HC-M
PL-TH-406-406	40x6	40x6	P-200	HC-M
PL-TH-503-503	50x3	50x3	P-150	HC-M
PL-TH-504-504	50x4	50x4	P-200	HC-M
PL-TH-505-505	50x5	50x5	P-200	HC-M
PL-TH-506-506	50x6	50x6	P-250	HC-M

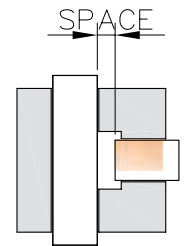

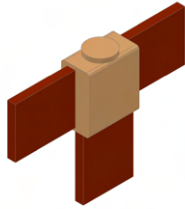

TEE VERTICAL (PL-TV)

Code	<b>BAR TO BAR (TEE VERTICAL)</b>			
	Conforms to IEC 62561-1			
	Flat Tape Conductor Size (A) (mm)	Flat Tape Conductor Size (B) (mm)	Powder	Handle Clamp
PL-TV-203-203	20x3	20x3	P-65	HC-M
PL-TV-253-253	25x3	25x3	P-65	HC-M
PL-TV-254-254	25x4	25x4	P-90	HC-M
PL-TV-256-256	25x6	25x6	P-150	HC-M
PL-TV-302-302	30x2	30x2	P-65	HC-M
PL-TV-303-303	30x3	30x3	P-90	HC-M
PL-TV-304-304	30x4	30x4	P-115	HC-M
PL-TV-305-305	30x5	30x5	P-115	HC-M
PL-TV-313-313	31x3	31x3	P-115	HC-M
PL-TV-316-316	31x6	31x6	P-200	HC-M
PL-TV-383-383	38x3	38x3	P-115	HC-M
PL-TV-385-385	38x5	38x5	P-150	HC-M
PL-TV-386-386	38x6	38x6	P-200	HC-M
PL-TV-403-403	40x3	40x3	P-115	HC-M
PL-TV-404-404	40x4	40x4	P-150	HC-M
PL-TV-405-405	40x5	40x5	P-150	HC-M
PL-TV-406-406	40x6	40x6	P-200	HC-M
PL-TV-503-503	50x3	50x3	P-200	HC-M
PL-TV-504-504	50x4	50x4	P-200	HC-M
PL-TV-505-505	50x5	50x5	P-200	HC-M
PL-TV-506-506	50x6	50x6	P-250	HC-M

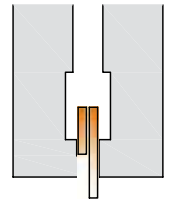

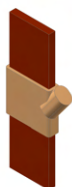

STRAIGHT VERTICAL (PL-V)

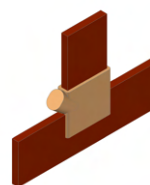

UPSIDE DOWN (PL-TS)

**Code** **BAR TO BAR (STRAIGHT VERTICAL)**

Conforms to IEC 62561-1

Code	Flat Tape Conductor Size (A) (mm)	Powder	Handle Clamp
PL-V-203	20x3	P-45	HC-M
PL-V-253	25x3	P-65	HC-M
PL-V-254	25x4	P-90	HC-M
PL-V-256	25x6	P-150	HC-M
PL-V-302	30x2	P-65	HC-M
PL-V-303	30x3	P-90	HC-M
PL-V-304	30x4	P-115	HC-M
PL-V-305	30x5	P-115	HC-M
PL-V-313	31x3	P-90	HC-M
PL-V-316	31x6	P-150	HC-M
PL-V-383	38x3	P-115	HC-M
PL-V-385	38x5	P-150	HC-M
PL-V-386	38x6	P-200	HC-M
PL-V-403	40x3	P-115	HC-M
PL-V-404	40x4	P-150	HC-M
PL-V-405	40x5	P-150	HC-M
PL-V-406	40x6	P-200	HC-M
PL-V-503	50x3	P-150	HC-M
PL-V-504	50x4	P-200	HC-M
PL-V-505	50x5	P-200	HC-M
PL-V-506	50x6	P-250	HC-M

**Code** **BAR TO BAR (UPSIDE DOWN)**

Conforms to IEC 62561-1

Code	Flat Tape Conductor Size (A) (mm)	Flat Tape Conductor Size (B) (mm)	Powder	Handle Clamp
PL-TS-203-203	20x3	20x3	P-65	HC-M
PL-TS-253-253	25x3	25x3	P-65	HC-M
PL-TS-254-254	25x4	25x4	P-90	HC-M
PL-TS-256-256	25x6	25x6	P-150	HC-M
PL-TS-302-302	30x2	30x2	P-65	HC-M
PL-TS-303-303	30x3	30x3	P-90	HC-M
PL-TS-304-304	30x4	30x4	P-115	HC-M
PL-TS-305-305	30x5	30x5	P-115	HC-M
PL-TS-313-313	31x3	31x3	P-115	HC-M
PL-TS-31-6316	31x6	31x6	P-200	HC-M
PL-TS-383-383	38x3	38x3	P-115	HC-M
PL-TS-385-385	38x5	38x5	P-150	HC-M
PL-TS-386-386	38x6	38x6	P-200	HC-M
PL-TS-403-403	40x3	40x3	P-115	HC-M
PL-TS-404-404	40x4	40x4	P-150	HC-M
PL-TS-405-405	40x5	40x5	P-150	HC-M
PL-TS-406-406	40x6	40x6	P-200	HC-M
PL-TS-503-503	50x3	50x3	P-200	HC-M
PL-TS-504-504	50x4	50x4	P-200	HC-M
PL-TS-505-505	50x5	50x5	P-200	HC-M
PL-TS-506-506	50x6	50x6	P-250	HC-M

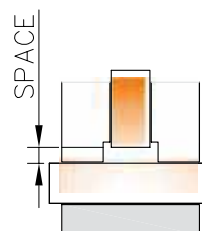

NOTE: SEICO is manufacturing and providing various special types of Moulds as per clients / Project demands which are not included in this section. Kindly contact our SEICO Sales Office for Special type of demands.

**SEICOWELD ACCESSORIES**

**MOULDS**



This is made of graphite block, a heat-resistant material which normally welds an average of 70 to 100 connections under normal size.

**HANDLE CLAMP (HCM/HCL)**



This is used for opening and closing the mould. The handle clamp(HC) is of two types depending on the mould size (HC-M & HC-L).

**HANDLE CLAMP (HCM1)**



The handle clamp with chain is designed to fit moulds into steel pipe, horizontal and vertical positions.

**IGNITION LIGHTER (IL)**



For Safety and quick ignition of the starting powder. Standard flint replacements are suitable. (IL)

**TAPE CLEANING BRUSH (CCB/TCB)**



For easy cleaning of conductor/Tape before welding. (CCB)

**MOULD BRUSH (MB)**



For cleaning safely the inner part of the mould. (MB)

**MOULD SCRAPER (MS)**

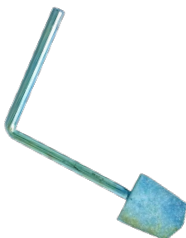

For removing easily the stags which accumulated in the crucible. (MS)

**NOTE: All pictures shown in the catalogue are for illustration purpose only. Actual product may vary due to product enhancement.**



# NOTES

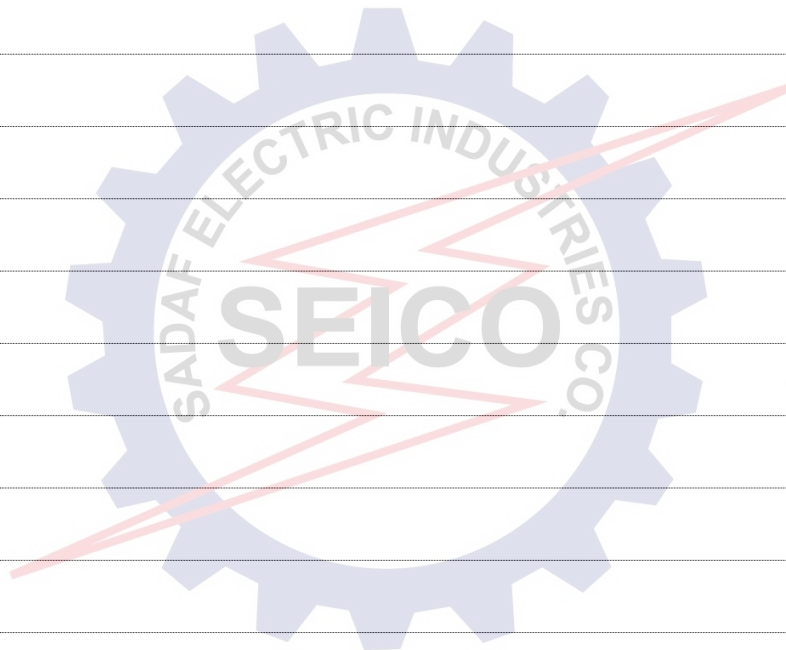



# NOTES

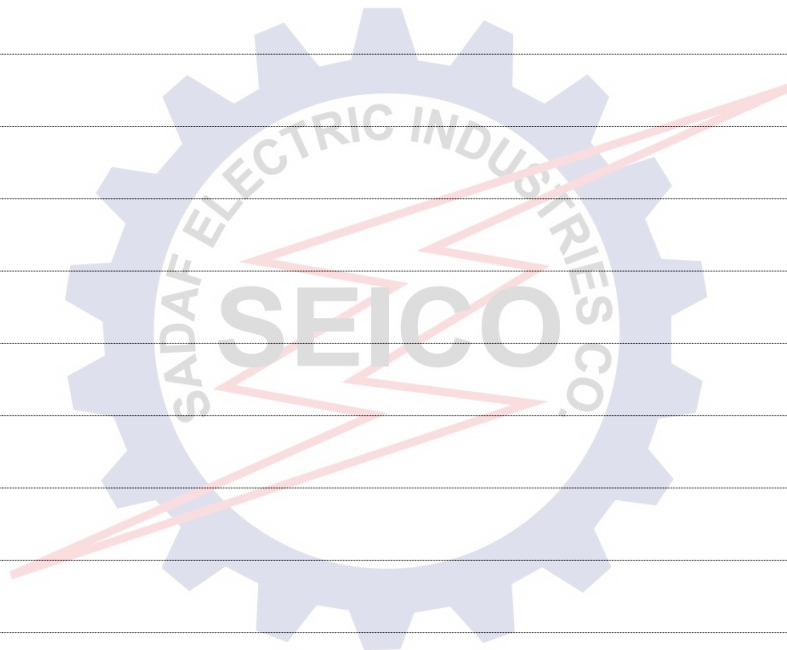



Sales and Technical Hot-line Inquiries: Please call us at **+96612 6080006**  
SEICO Factory

Jeddah - Kingdom of Saudi Arabia  
Industrial City - Zone 5,  
P.O. Box 16943, Jeddah 21474

Tel.: +966126080006  
E-mail: [sales@seico-sa.com](mailto:sales@seico-sa.com)  
[www.seico-sa.com](http://www.seico-sa.com)



**QR CODE OF OUR  
OFFICIAL WEBSITE**



**SADAF ELECTRIC INDUSTRIES CO.**

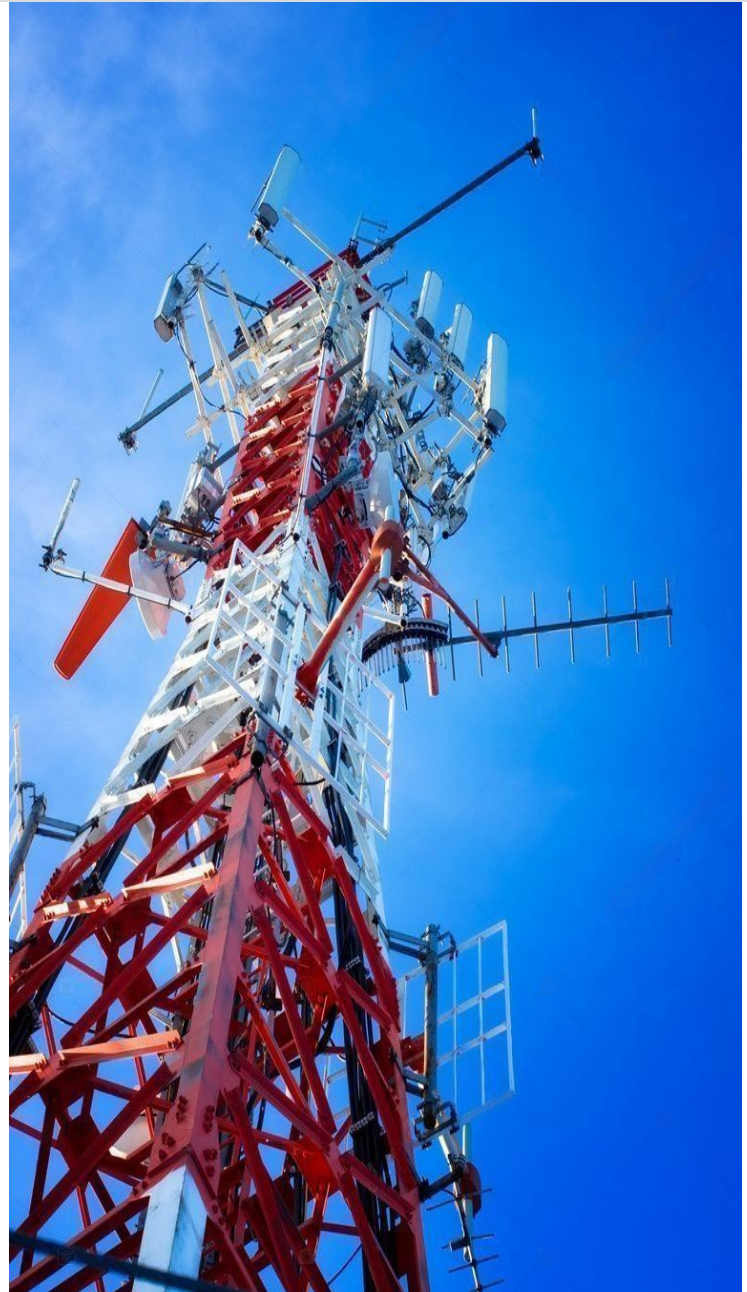

SADAF ELECTRIC INDUSTRIE CO. (SEICO)

EARTHING AND LIGHTNING PROTECTION (MAIN CATALOGUE)

**FOLLOW US ON**

[www.seico-sa.com](http://www.seico-sa.com)

